



# GP<sup>®</sup>1 SAM

GP<sup>®</sup>1 SAM, the gas protection self adhesive membrane, is a bituminous gas proof and water proof sheet, composed of self-adhesive SBS polymer modified bitumen incorporating GP<sup>®</sup> 1 with an upper surface finish of black reinforced LDPE, and a lower surface finish of siliconized release film.

**Features and benefits:**

- High quality reinforced membrane.
- Low permeability to hydrocarbon and VOC vapours, carbon dioxide, methane and radon.
- Complies with latest codes of practice as published by the BRE and CIRIA, and BS 8485.

Can be used on any site in accordance with BS8485:2015 and NHBC requirements where carbon dioxide, methane or radon is present up to and including CIRIA 665 SITUATION 6. The barrier is sufficiently resistant to the ingress of harmful gasses into a building. On more heavily contaminated sites a passive or active venting system may be required to dilute the gasses down to acceptable levels and specific design advice should be sought.

**Accessory Products**

- GP<sup>®</sup>1
- GP<sup>®</sup> DPC
- 300TT
- GP<sup>®</sup> Tape
- GP<sup>®</sup> Lap Tape

**Physical Properties**

<b>Thickness</b>	1.2 mm
<b>Width</b>	0.3 m or 0.9 m
<b>Length</b>	20 m
<b>Weight</b>	1100 g/m <sup>2</sup>

**Gas Permeability**

<b>Methane</b>	< 0.68
<b>Carbon Dioxide</b>	< 2.81
<b>Radon</b>	8.0 x 10 <sup>-15</sup>

**Compliance and Certification**

CE MARK - EN13967:2012 + A1 2019 :2017 Type (A/T)  
**NHBC Standards Compliant**  
 BS8485:2015 + A1 2019  
 Accordant BBA Certified - Certificate No. 22/6076

**Specification Clauses**

**Uniclass 2015:**  
 PR\_25\_57\_08\_08 Plastic Sheets  
**CAWS:**  
 J40/45 Self-adhesive bitumen gas retardant damp proofing/ tanking  
 J40/40 Self-adhesive bitumen damp proofing/ tanking  
 J40/190 Self-adhesive bitumen damp proofing/ tanking  
 J40/180 Self-adhesive bitumen gas retardant damp proofing/ tanking



Please Scan





## Standard Detail - Ground Bearing Raft Slab

**NB- All DPC's & membranes interrupting masonry bed joints are required to be bedded above and below with mortar.**

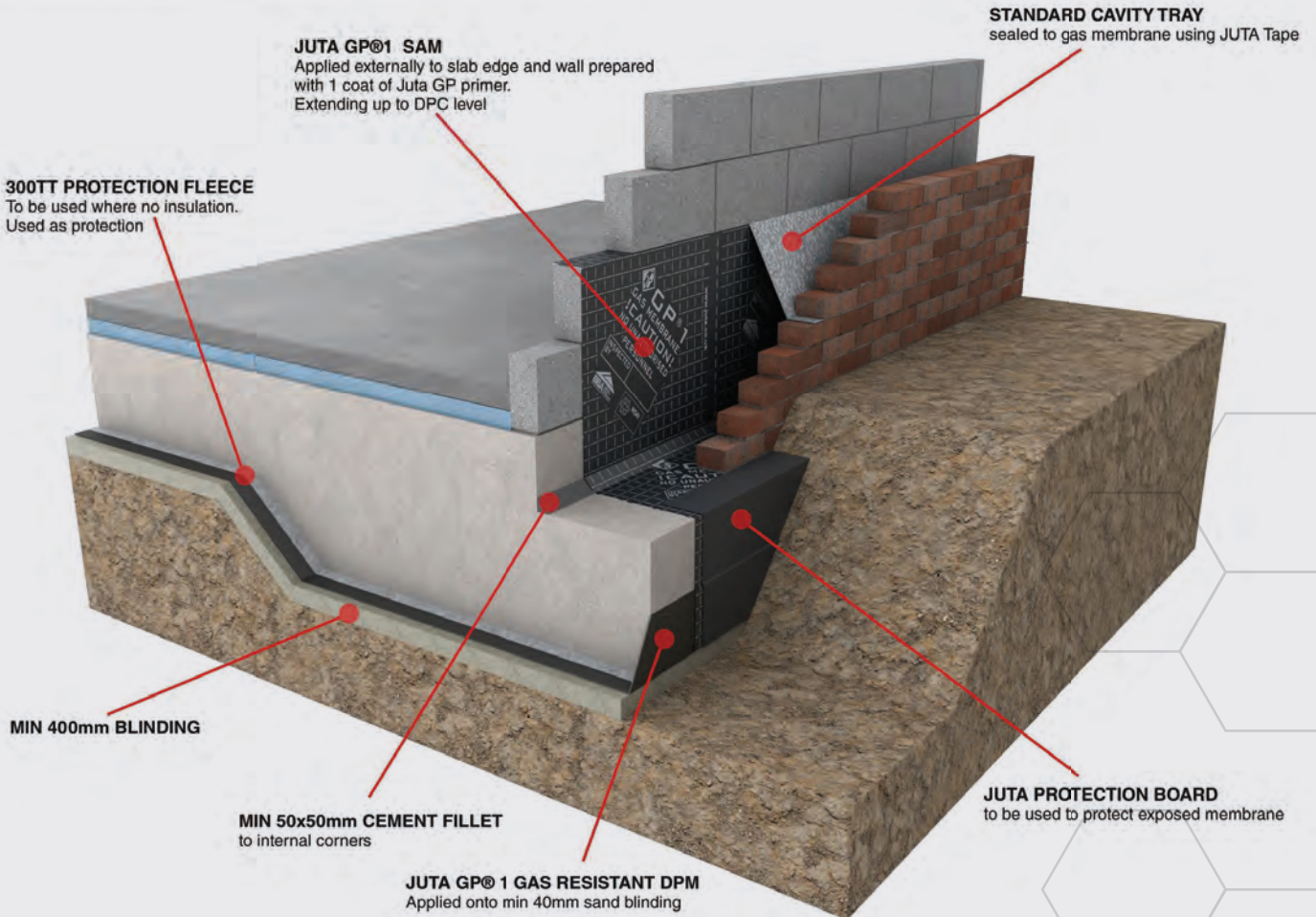

Various typical details available on request. Please contact [technical@juta.co.uk](mailto:technical@juta.co.uk) for further information



## Standard Detail - Ground Bearing Slab

**NB- All DPC's & membranes interrupting masonry bed joints are required to be bedded above and below with mortar.**

**300TT PROTECTION FLEECE**  
To be used where no insulation.  
Used as protection

**STANDARD CAVITY TRAY**  
sealed to gas membrane using JUTA Tape

**BLINDING**

**JUTA GP DPC**  
Juta GP1 can be used as the DPC providing there is no lateral shear as per BS8215:1991. If lateral shear is a design consideration then Juta GP DPC to be used

**JUTA GP<sup>1</sup> TAPE**  
Taped joint or heat welded seam joint

**JUTA GP<sup>1</sup> GAS RESISTANT DPM**  
Applied onto min 400mm sand blinding

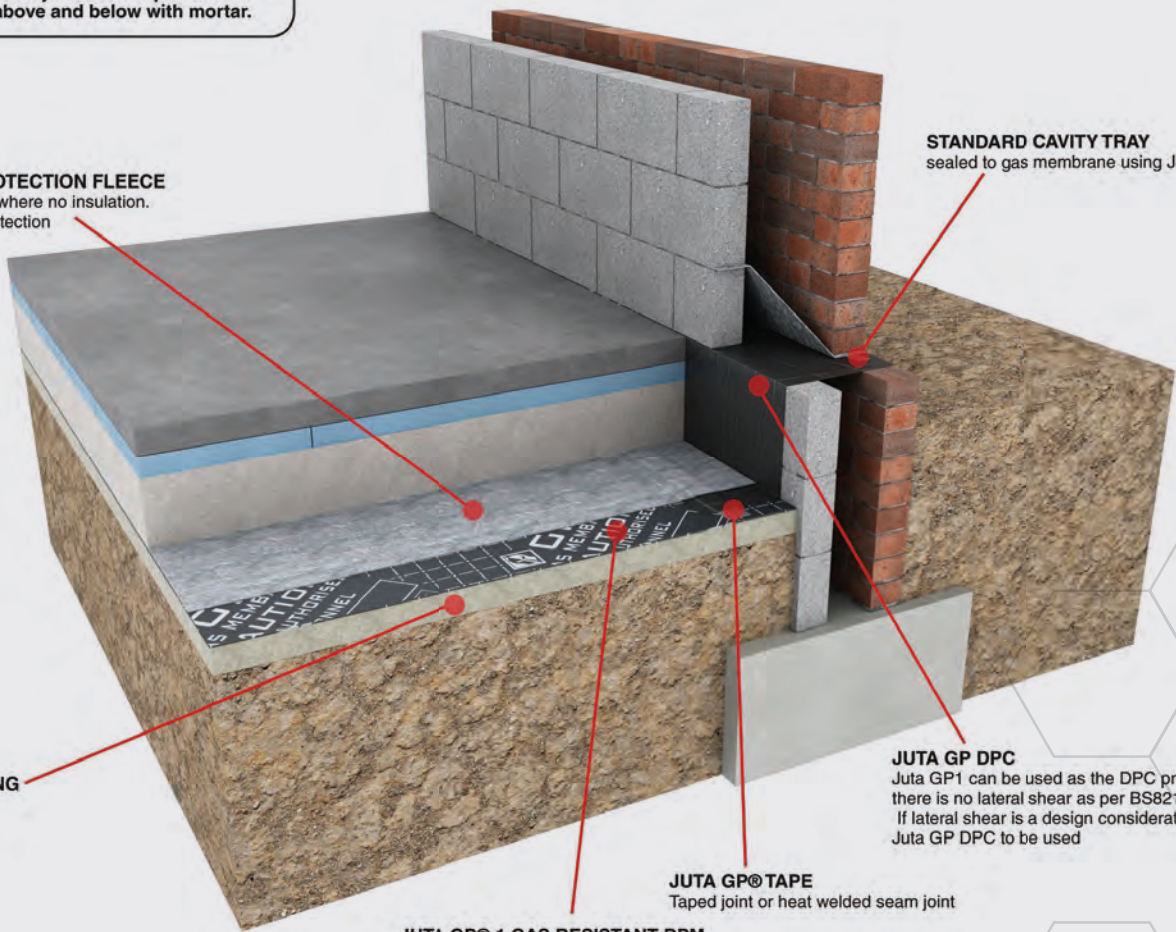

Various typical details available on request. Please contact **technical@juta.co.uk** for further information



## Standard Detail - Ground Block & Beam Flooring

**NB- All DPC's & membranes interrupting masonry bed joints are required to be bedded above and below with mortar.**

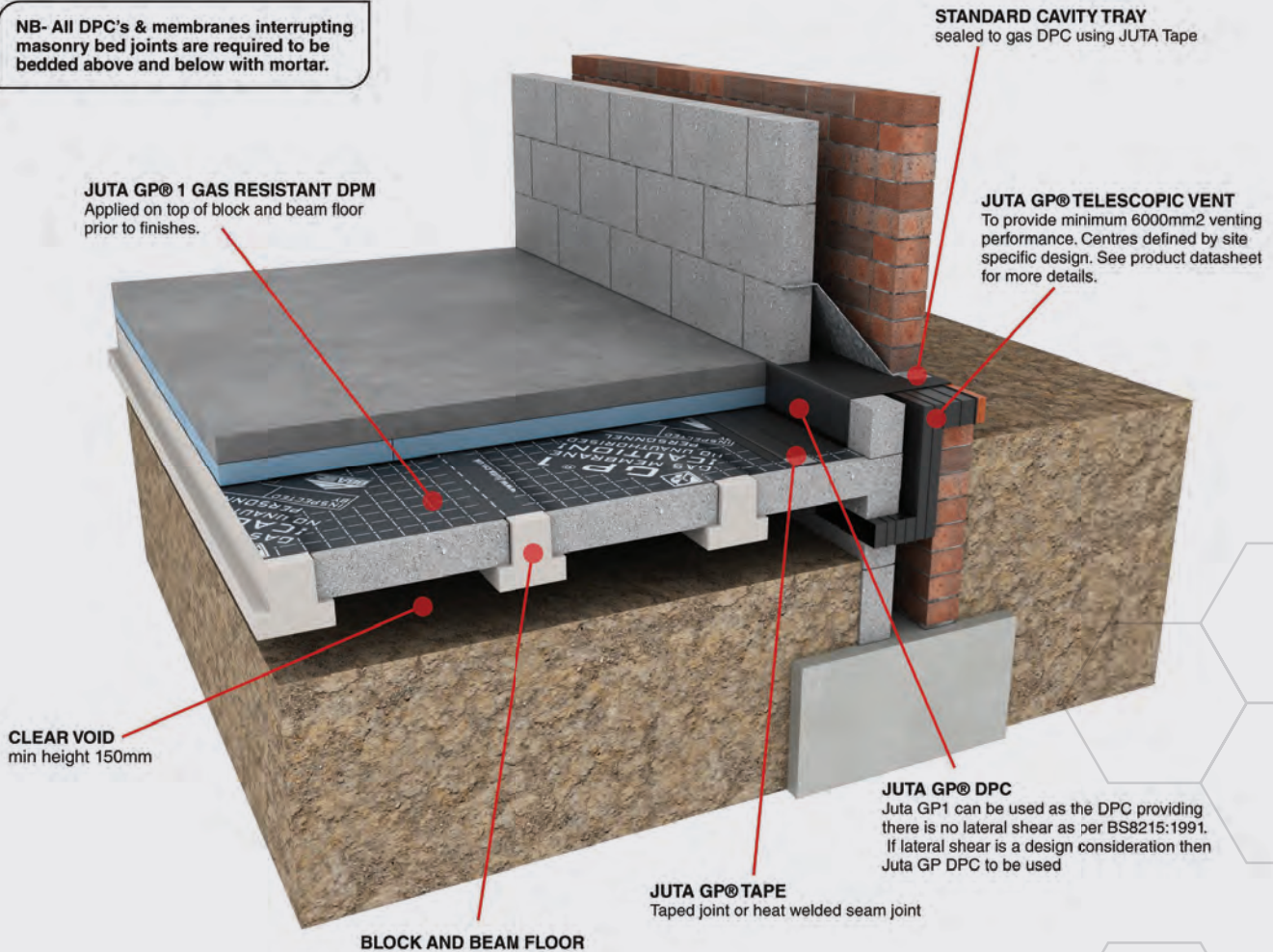

Various typical details available on request. Please contact [technicalejuta.co.uk](mailto:technicalejuta.co.uk) for further information