

JUTA PD1700 (PROTECT & DRAIN)
APPLIED EXTERNALLY AS PROTECTION
PRIOR TO BACKFILLING - TO BE
EXTENDED DOWN TO LAND DRAIN

JUTA WP SAM APPLIED
EXTERNALLY TO WALL PREPARED
WITH 2 COATS OF JUTA GP PRIMER.

ALL CORNERS TO BE REINFORCED
WITH A MIN. 40mm CEMENT FILLET
AND 300mm WIDE REINFORCING
STRIP OF JUTA GP SAM

GRANULAR FILL DRAINAGE
BACKFILL MATERIAL

SUGGESTED MAINTAINABLE
LAND DRAIN LOCATION AS
BS8102:2009 RECOMMENDATIONS

JUTA HYDROLOCK - PRE APPLIED
ONTO SAND BLINDING BEFORE
SLAB POURED

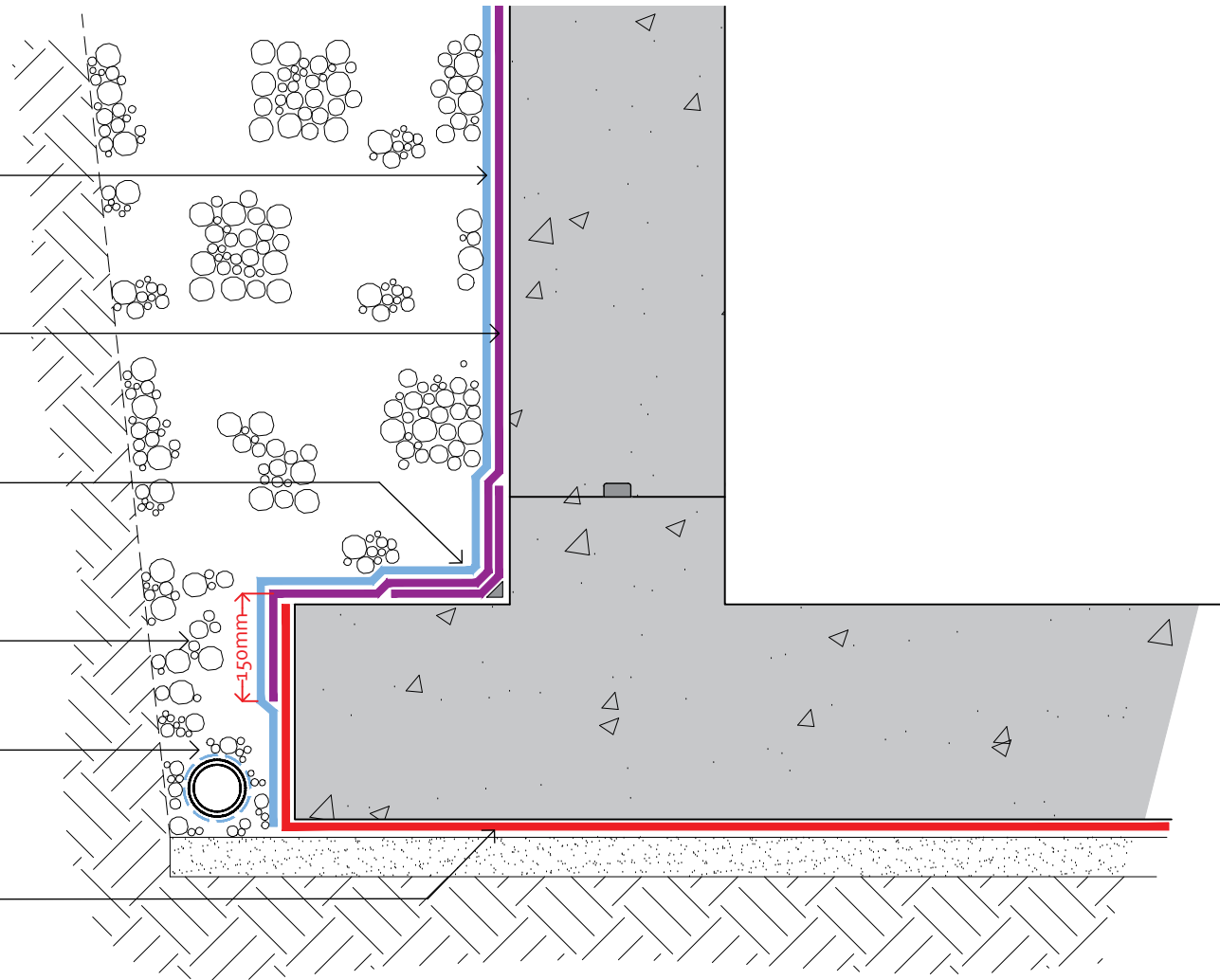

CLIENT JUTA UK LTD

PROJECT WP SAM Standard Details



- NOTES
- Detail is generic to application so should be used as a guide not a specific installation detail.
 - JUTA suggest that waterproofing membranes including JUTA WP SAM should be installed by suitably experienced persons. If unfamiliar with products and applications, please contact JUTA for Specialist Contractors Details.
 - JUTA WP SAM can be applied to reinforced concrete, concrete blockwork and masonry. It can also be applied to various masonry wall systems (i.e. ICF or Stepoc.) but please contact JUTA or a specialist to confirm suitability of primers and adhesive on structure.
 - All surfaces must be prepared with 2 coats of JUTA GP Primer before application. A minimum of 2hrs must be left between coats to allow the primer to become tacky to aid adhesion. Please refer to JUTA WP SAM Installation Guide for further information
 - All externally applied membrane should be protected from damage prior to backfilling. This can be achieved using standard protection boards or better still, JUTA PD1700 which is a protection and drainage sheet layer which additionally creates a void between the membrane and earth to reduce the change of hydrostatic pressure onto the structure and direct any groundwater to land drain locations.
 - All design decisions made by others that might have an impact on the gas and waterproof design performance should be brought to the attention of the design team and Juta UK Ltd. Final decisions and/or any recommendations should be approved by the design team and Juta UK Ltd.
 - Dimensions are not to be scaled from this drawing. All written measurements are to be checked on site by the contractor.
 - All rights described in chapter IV of the copyright, design and patents act 1988 have been generally asserted.

DRAWING TITLE
**JUTA WP SAM (SELF ADHESIVE MEMBRANE)
RC RETAINING WALL/ SLAB WITH TOE DETAIL**

DRAWING NUMBER
TD-JUTA.WP-SAM.005

DRAWN BY PD	CHECKED BY PF	SCALE Not to Scale	DATE Mar. 2020
----------------	------------------	-----------------------	-------------------

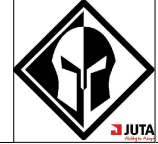

MELTON GROVE WORKS
BLACKPOOL ROAD
LYTHAM
FY8 5PL
Tel: 01772 754177