

JUTA GP SAM ADHESIVE FACE TO BE FOLDED BACK ON ITSELF AND LAPPED ONTO SCREED TO ALLOW SUBSEQUENT LAP OF MEMBRANE BELOW SLAB. SEE DETAIL ADJACENT

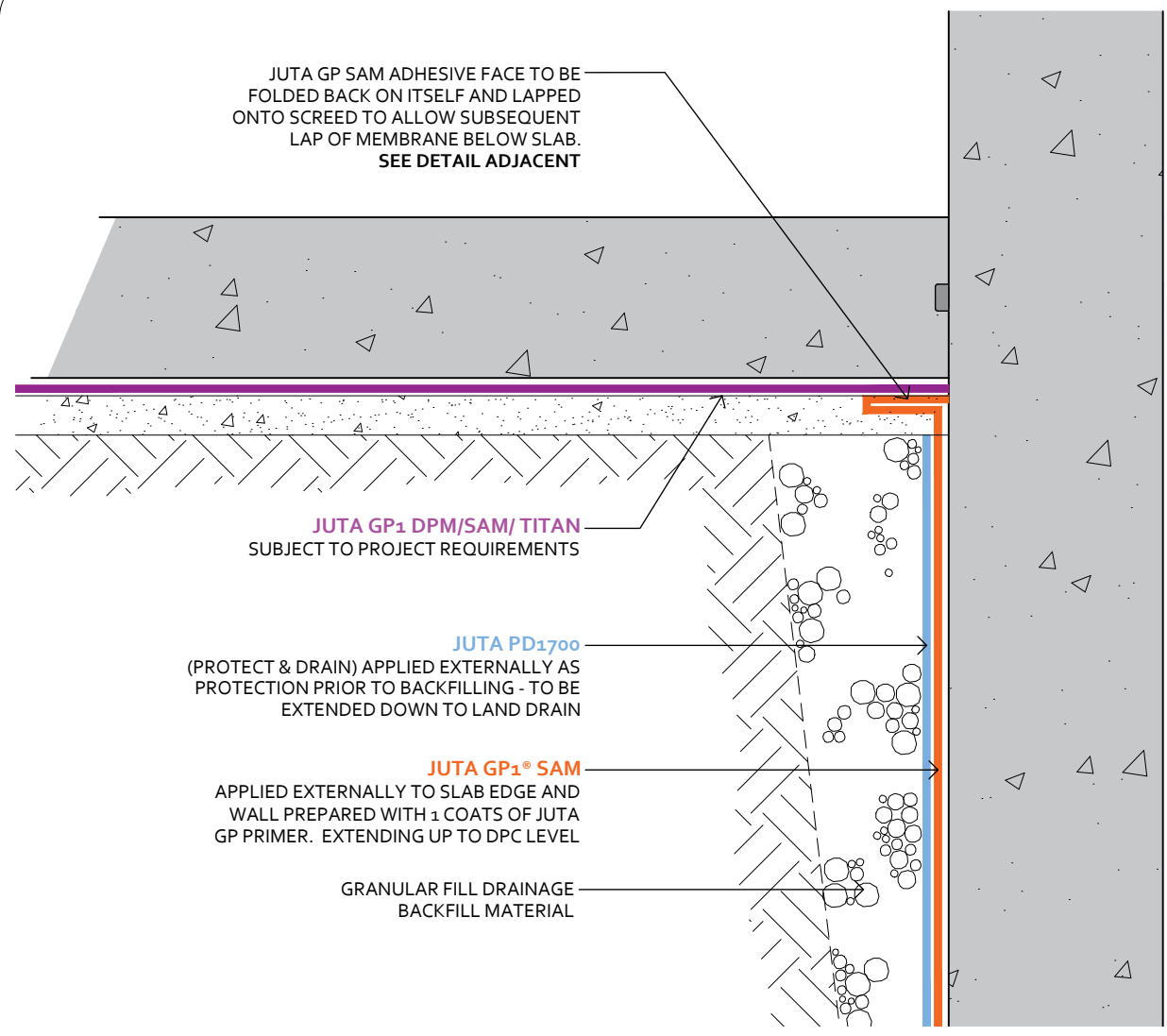

**JUTA GP1 DPM/SAM/ TITAN**  
SUBJECT TO PROJECT REQUIREMENTS

**JUTA PD1700**  
(PROTECT & DRAIN) APPLIED EXTERNALLY AS PROTECTION PRIOR TO BACKFILLING - TO BE EXTENDED DOWN TO LAND DRAIN

**JUTA GP1® SAM**  
APPLIED EXTERNALLY TO SLAB EDGE AND WALL PREPARED WITH 1 COATS OF JUTA GP PRIMER. EXTENDING UP TO DPC LEVEL

GRANULAR FILL DRAINAGE BACKFILL MATERIAL

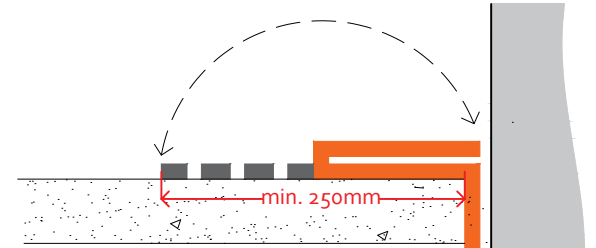

ENSURE A MINIMUM 250mm OF MEMBRANE IS FOLDED BACK AND NOT ADHERED TO THE WALL BEFORE THE PROTECTION FILM IS REMOVED

REMOVE THE FILM AND FOLD THE ADHESIVE FACE BACK ON ITSELF TO CREATE A MIN. 100mm LEADING EDGE FOR SUBSEQUENT LAPPING.

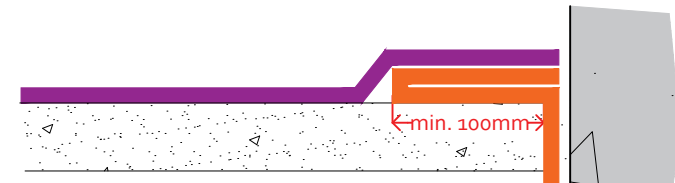

ENSURE SCREED IS PRIMED BEFORE APPLYING JUTA GP SAM AND LAPPING MIN.100mm ONTO LEADING EDGE OF LAP FROM VERTICAL MEMBRANE.

CLIENT  
**JUTA UK LTD**

PROJECT  
**JUTA GP1® SAM Typical Details**

**NOTES**

- Detail is generic to application so should be used as a guide not a specific installation detail.
- JUTA suggest that waterproofing membranes including JUTA GP1 SAM should be installed by suitably experienced persons. If unfamiliar with products and applications, please contact JUTA for Specialist Contractors Details.
- JUTA GP1 SAM can be applied to reinforced concrete, concrete blockwork and masonry. It can also be applied to various masonry wall systems (i.e. ICF or Stepoc.) but please contact JUTA or a specialist to confirm suitability of primers and adhesive on structure.
- All surfaces must be prepared with 1 coats of JUTA GP Primer before application. Please refer to JUTA SAM Installation Guide for further information
- All externally applied membrane should be protected from damage prior to backfilling. This can be achieved using standard protection boards or better still, JUTA PD1700 which is a protection and drainage sheet layer which additionally creates a void between the membrane and earth to reduce the change of hydrostatic pressure onto the structure and direct any groundwater to land drain locations.
- All design decisions made by others that might have an impact on the gas and waterproof design performance should be brought to the attention of the design team and Juta UK Ltd. Final decisions and/or any recommendations should be approved by the design team and Juta UK Ltd.
- Dimensions are not to be scaled from this drawing. All written measurements are to be checked on site by the contractor.
- All rights described in chapter IV of the copyright, design and patents act 1988 have been generally asserted.

**DRAWING TITLE**  
**JUTA GP1® SAM**  
VERTICAL TO HORIZONTAL TRANSITION DETAIL -  
(OPTION B: REVERSE FOLDED LAP DETAIL)

**DRAWING NUMBER**  
JUTA.GP1-SAM.014

<b>DRAWN BY</b> PD	<b>CHECKED BY</b> PF	<b>SCALE</b> Not to Scale	<b>DATE</b> Mar. 2020
-----------------------	-------------------------	------------------------------	--------------------------

MELTON GROVE WORKS  
BLACKPOOL ROAD  
LYTHAM  
FY8 5PL  
Tel: 01772 754177